

**From:** [Cascade Irrigation](#)  
**To:** [Jeremiah Cromie](#)  
**Subject:** RE: RU-22-00003 Calvary Ellensburg - Notice of Application  
**Date:** Thursday, October 6, 2022 2:01:46 PM

---

**CAUTION:** This email originated from outside the Kittitas County network. Do not click links, open attachments, fulfill requests, or follow guidance unless you recognize the sender and have verified the content is safe.

Cascade Irrigation has no objection to the reasonable use as long as it does not interfere with water to downstream customers.

---

**From:** Jeremiah Cromie <jeremiah.cromie@co.kittitas.wa.us>  
**Sent:** Thursday, October 6, 2022 1:04 PM  
**To:** Kim Dawson <kim.dawson@co.kittitas.wa.us>; George Long <long@kittcom.org>; Julie Kjorsvik <julie.kjorsvik@co.kittitas.wa.us>; Toni Berkshire <toni.berkshire@co.kittitas.wa.us>; PublicHealth Inspectors <PublicHealthInspectors@co.kittitas.wa.us>; Lisa Lawrence <lisa.lawrence@co.kittitas.wa.us>; Patti Stacey <patti.stacey@co.kittitas.wa.us>; Kelee Hodges <kelee.hodges.pw@co.kittitas.wa.us>; Codi Fortier <codi.fortier@co.kittitas.wa.us>; 'enviroreview@yakama.com' <enviroreview@yakama.com>; 'corrine\_camuso@yakama.com' <corrine\_camuso@yakama.com>; 'jessica\_lally@yakama.com' <jessica\_lally@yakama.com>; 'noah\_oliver@yakama.com' <noah\_oliver@yakama.com>; 'casey\_barney@yakama.com' <casey\_barney@yakama.com>; 'kozj@yakamafish-nsn.gov' <kozj@yakamafish-nsn.gov>; 'matj@yakamafish-nsn.gov' <matj@yakamafish-nsn.gov>; 'barh@yakamafish-nsn.gov' <barh@yakamafish-nsn.gov>; 'tebu461@ecy.wa.gov' <tebu461@ecy.wa.gov>; 'lowh461@ECY.WA.GOV' <lowh461@ECY.WA.GOV>; 'FormerOrchards@ecy.wa.gov' <FormerOrchards@ecy.wa.gov>; 'wendy.neet@ecy.wa.gov' <wendy.neet@ecy.wa.gov>; 'crosepa@ecy.wa.gov' <crosepa@ecy.wa.gov>; 'Scott.Downes@dfw.wa.gov' <Scott.Downes@dfw.wa.gov>; 'Jennifer.Nelson@dfw.wa.gov' <Jennifer.Nelson@dfw.wa.gov>; 'Elizabeth.Torrey@dfw.wa.gov' <Elizabeth.Torrey@dfw.wa.gov>; 'sepa@dahp.wa.gov' <sepa@dahp.wa.gov>; 'jorgenja@cwu.edu' <jorgenja@cwu.edu>; 'nelmsk@cwu.edu' <nelmsk@cwu.edu>; Jeremy Larson <jeremy.larson@co.kittitas.wa.us>; Steph Mifflin <stephanie.mifflin@co.kittitas.wa.us>; 'russell.mau@doh.wa.gov' <russell.mau@doh.wa.gov>; 'rivers@dnr.wa.gov' <rivers@dnr.wa.gov>; 'brenda.young@dnr.wa.gov' <brenda.young@dnr.wa.gov>; 'luke.warthen@dnr.wa.gov' <luke.warthen@dnr.wa.gov>; 'SEPACENTER@dnr.wa.gov' <SEPACENTER@dnr.wa.gov>; 'Garren.Andrews@dnr.wa.gov' <Garren.Andrews@dnr.wa.gov>; 'MARTIN.MAUNEY@dnr.wa.gov' <MARTIN.MAUNEY@dnr.wa.gov>; 'brooksideconsulting@gmail.com' <brooksideconsulting@gmail.com>; 'tribune@nkctribune.com' <tribune@nkctribune.com>; 'terry@nkctribune.com' <terry@nkctribune.com>; 'mbreckenridge@kvnews.com' <mbreckenridge@kvnews.com>; 'legals@kvnews.com'

**From:** [Adam Osbekoff](#)  
**To:** [Jeremiah Cromie](#)  
**Subject:** RE: RU-22-00003 Calvary Ellensburg - Notice of Application  
**Date:** Friday, October 7, 2022 12:48:59 PM

---

**CAUTION:** This email originated from outside the Kittitas County network. Do not click links, open attachments, fulfill requests, or follow guidance unless you recognize the sender and have verified the content is safe.

Hello Jeremiah

The Snoqualmie Tribe [Tribe] is a federally recognized sovereign Indian Tribe. We were signatory to the Treaty of Point Elliott of 1855; we reserved certain rights and privileges and ceded certain lands to the United States. As a signatory to the Treaty of Point Elliot, the Tribe specifically reserved among other things, the right to fish at usual and accustomed areas and the “privilege of hunting and gathering roots and berries on open and unclaimed lands” off-reservation throughout the modern-day state of Washington.

Thank you for the opportunity to review and comment. Based on the information provided and our understanding of the project and its APE we have no substantive comments to offer at this time. However, please be aware that if the scope of the project or the parameters for defining the APE change we reserve the right to modify our current position.

Thank you

Adam Osbekoff

---

**From:** Jeremiah Cromie [mailto:jeremiah.cromie@co.kittitas.wa.us]  
**Sent:** Thursday, October 6, 2022 1:04 PM  
**To:** Kim Dawson <kim.dawson@co.kittitas.wa.us>; George Long <long@kittcom.org>; Julie Kjorsvik <julie.kjorsvik@co.kittitas.wa.us>; Toni Berkshire <toni.berkshire@co.kittitas.wa.us>; PublicHealth Inspectors <PublicHealthInspectors@co.kittitas.wa.us>; Lisa Lawrence <lisa.lawrence@co.kittitas.wa.us>; Patti Stacey <patti.stacey@co.kittitas.wa.us>; Kelee Hodges <kelee.hodges.pw@co.kittitas.wa.us>; Codi Fortier <codi.fortier@co.kittitas.wa.us>; 'enviroreview@yakama.com' <enviroreview@yakama.com>; 'corrine\_camuso@yakama.com' <corrine\_camuso@yakama.com>; 'jessica\_lally@yakama.com' <jessica\_lally@yakama.com>; 'noah\_oliver@yakama.com' <noah\_oliver@yakama.com>; 'casey\_barney@yakama.com' <casey\_barney@yakama.com>; 'kozj@yakamafish-nsn.gov' <kozj@yakamafish-nsn.gov>; 'matj@yakamafish-nsn.gov' <matj@yakamafish-nsn.gov>; 'barh@yakamafish-nsn.gov' <barh@yakamafish-nsn.gov>; 'tebu461@ecy.wa.gov' <tebu461@ecy.wa.gov>; 'lowh461@ECY.WA.GOV' <lowh461@ECY.WA.GOV>; 'FormerOrchards@ecy.wa.gov' <FormerOrchards@ecy.wa.gov>; 'wendy.neet@ecy.wa.gov' <wendy.neet@ecy.wa.gov>;



# CITY OF ELLENSBURG

Public Works Department  
501 N. Anderson St.; Ellensburg, WA 98926  
Ph: (509) 962-7230 Fax: (509) 962-7127

## Memorandum

**Date:** October 18, 2022  
**To:** Jeremy Cromie, County Planner II  
**From:** Craig Jones, City Development Coordinator *CJ*  
**Through:** Derek Mayo, City Engineer *DKM*  
**Re:** Calvary Church Expansion – RU-22-00003

The following are the City Public Works comments on the Reasonable Use for the proposed Calvary Church Expansion at Vantage Hwy and Cowboy Ln.

The applicant can view the City of Ellensburg's Development Standards on the City's website for more information. <http://www.ci.ellensburg.wa.us/index.aspx?NID=339>

At time of civil plan review, Staff will work with the developer's engineer regarding the specific issues related to frontage and utility improvements.

### Water:

The water main available to serve this development is a 12" Ductile Iron main that runs in Vantage Hwy and stops approximately 680'+/- from the proposed project. The developer will need to extend the main to the farthest east extents of the property being developed along Vantage Hwy. The existing buildings on site will need to connect to City water. See attached utility map.

Fire hydrant placement shall be per Fire Department requirements. Developer's engineer may be required to verify that fire flow capacity will meet the necessary requirements.

Specific issues related to water main and meter locations will be addressed at project civil submittal.

### Sewer:

The sewer main available to serve this development is a 12" PVC main that runs in Vantage Hwy and stops the same location as water. The developer will need to extend the sewer main to the farthest east extents of the property being developed. The existing buildings on site are served by an onsite septic system that will need to be abandoned and connected to City. See attached utility map.

Specific issues related to sewer main and side sewer construction will be addressed at project civil submittal.

**Roadway and access:**

This project will trigger the requirement for half street improvements along the Vantage Hwy frontage of the development. Vantage Hwy is classified as a principle arterial street and will be a minimum 104' right of way at full build out. Street improvements include concrete curb/gutter, sidewalks, street lighting, permanent signage, asphalt, asphalt markings, gravel base, storm drainage, and other items associated with minimum public improvements consistent with Public Works Development Standards. Under the Land Development Code the sidewalks will need to be separated from the curb. Existing power poles may need to be relocated to accommodate these frontage improvements. Developer may apply for a deferral of said frontage improvements. The Public Works Director and City Council will make a determination on if the improvements could be deferred if requested. A Transportation Concurrency Application may need to be filled out and submitted to the County. The application can be found on the County's website. At a minimum the City will request that a Trip Generation and Distribution Letter be completed for review of the project. A full Traffic Impact Analyses may be required depending on the findings from the Trip Generation and Distribution Letter.

Specific issues related to roadway and access construction will be addressed at project civil submittal.

**Stormwater:**

There is a drainage ditch along the south side of the parcel. Stormwater outfall could be discharged here after on site treatment and flow control were met. See attached utility map.

The applicant shall use the current Stormwater Management Manual for Eastern Washington, or approved equivalent for reference in design of stormwater treatment and flow control for post construction requirements for new development and redevelopment. The design shall at a minimum use the following design storms, or as recommended for the proposed BMP, whichever is greater. Treatment shall be designed for the first ½" of rainfall on the property, and storm drainage detention on a 10 year storm event (1.2" of precipitation/24 hours) and retention facilities based on a 25 year storm event (1.6" of precipitation/24 hours). Specific issues related to storm water will be reviewed at time of civil plan submittal.

The applicant's design engineer should determine groundwater elevations in the vicinity of proposed storm water treatment and flow control facilities. The water surface elevation needs to be utilized in the facility designs and should be verified when groundwater is at its highest. Typically the groundwater in the Ellensburg area is elevated from April 15<sup>th</sup> through October 15<sup>th</sup>. However, groundwater on the subject site may not be associated with seasonal irrigation and could crest at another time during the year.

The following comments are from the City Stormwater Department;

1. If the site is an acre or greater the developer will need to make Notice of Intent (NOI) with Ecology and apply for a Stormwater General Construction Permit months in advance of construction. <https://ecology.wa.gov/Regulations-Permits/Permits-certifications/Stormwater-general-permits/Construction-stormwater-permit>
2. The Ecology permit requires a Stormwater Pollution Prevention Plan (SWPPP) be submitted with the plan set and be reviewed by the City of Ellensburg Stormwater Utility along with a set of temporary sediment erosion control plans (TESC).

3. In addition, Ecology now requires an Operation and Maintenance (O&M) Plan be submitted to the City for review and retainage. The O&M Plan must address the long term maintenance of the stormwater facilities (swales) that will be constructed onsite to deal with the flow control and treatment requirements of Core Element 5&6 in the Eastern Washington Stormwater Management Manual.

Here is a link for additional information from Ecology;

<https://ecology.wa.gov/Regulations-Permits/Permits-certifications/Stormwater-general-permits/Construction-stormwater-permit/eCoverage-packet>

**Other issues:**

During civil plan review, Public Works establishes the preliminary addressing plan, the developer will need to work with the Post Office to establish the mail delivery routing plan and mailbox locations. The Post Office requires the use of metal Collection Box Unit style mailboxes.

The developer is required to obtain all other permits (HPA if required, DOE construction site grading permit, etc.) that may be required as a result of plat development.

A Utility Extension Agreement will need to be completed by the Developer and City prior to civil plan review. City Code also requires that if you want one utility you take water, sewer and electric.

Additional utility easements may be required for any proposed utility outside of the right of way. Specific issues will be addressed at civil plan submittal.

Irrigation water will need to comply with Irrigation District requirements, and be continued through the site to downstream users.

Site plan will need to comply with the City's Public Works Development Standards for parking and stormwater.

Any work being done in the right of way will require permits and the contractor to have proper insurance and bonding on file with the City.

City and County will work together on the civil plan review for this development.

Cc File 22-073

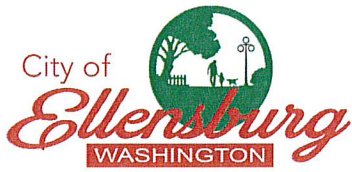

CITY OF ELLENSBURG  
 PUBLIC WORKS DEPARTMENT  
 UTILITY MAP REQUEST INFORMATION

W  
A  
T  
E  
R

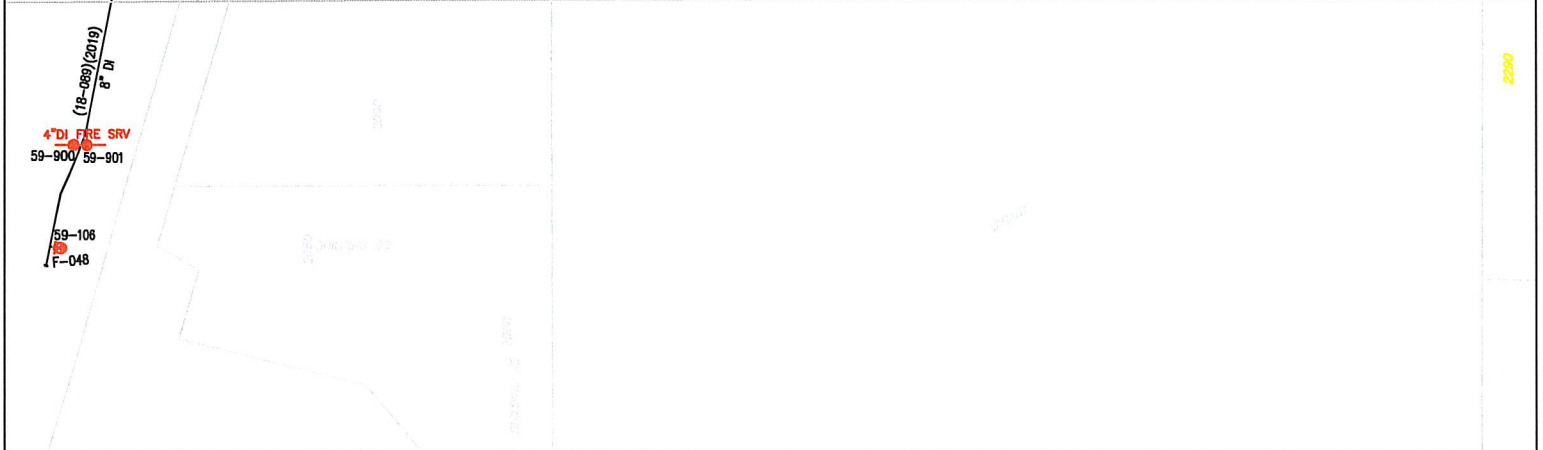

**DISCLAIMER:**

THE CITY OF ELLENSBURG PUBLIC WORKS DEPARTMENT CANNOT VERIFY THE ACCURACY OF THE UTILITIES REPRESENTED ON THIS PLAN. THEY ARE DISPLAYED FOR EASE OF PLANNING AND INSTALLATION AND ARE BASED UPON THE BEST INFORMATION AVAILABLE. CONTRACTORS AND DEVELOPERS SHOULD REFER TO CIVIL PLANS FOR MOST CURRENT DESIGN REVISION AND CALL 811 BEFORE YOU DIG.



Know what's below.  
 Call before you dig.



CITY OF ELLENSBURG  
 PUBLIC WORKS DEPARTMENT  
 UTILITY MAP REQUEST INFORMATION

SEWER



93  
 608.7  
 1506.3  
 1506.4  
 T 1596.2

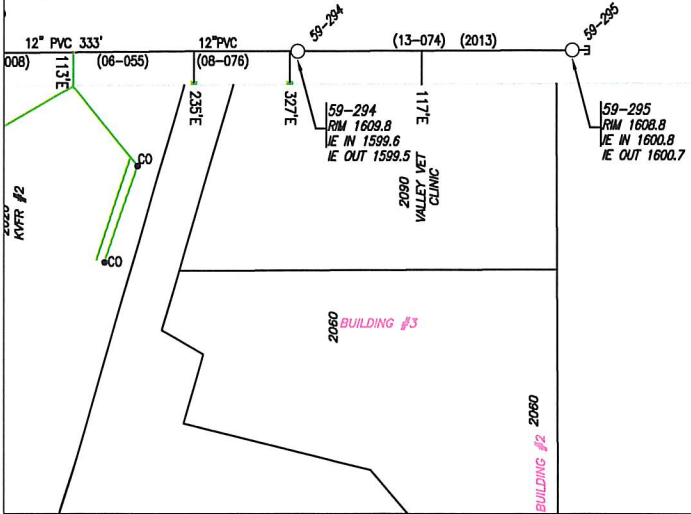

**DISCLAIMER:**  
 THE CITY OF ELLENSBURG PUBLIC WORKS DEPARTMENT CANNOT VERIFY THE ACCURACY OF THE UTILITIES REPRESENTED ON THIS PLAN. THEY ARE DISPLAYED FOR EASE OF PLANNING AND INSTALLATION AND ARE BASED UPON THE BEST INFORMATION AVAILABLE. CONTRACTORS AND DEVELOPERS SHOULD REFER TO CIVIL PLANS FOR MOST CURRENT DESIGN REVISION AND CALL 811 BEFORE YOU DIG.



Know what's below.  
 Call before you dig.



**DISCLAIMER:**  
THE CITY OF ELLENSBURG PUBLIC WORKS DEPARTMENT CANNOT VERIFY THE ACCURACY OF THE UTILITIES REPRESENTED ON THIS PLAN. THEY ARE DISPLAYED FOR EASE OF PLANNING AND INSTALLATION AND ARE BASED UPON THE BEST INFORMATION AVAILABLE. CONTRACTORS AND DEVELOPERS SHOULD REFER TO CIVIL PLANS FOR MOST CURRENT DESIGN REVISION AND CALL 811 BEFORE YOU DIG.





**From:** [PublicHealth Inspectors](#)  
**To:** [Jeremiah Cromie](#)  
**Subject:** RE: RU-22-00003 Calvary Ellensburg - Notice of Application  
**Date:** Wednesday, October 19, 2022 3:52:08 PM

---

Jeremiah,

Public health has reviewed this application. The intention is for the project to connect to the City of Ellensburg sewer and water within the next two years. However, in the interim, the current well must be tested for bacteria and nitrates. The septic tank must be pumped and inspected (with pumping records submitted to the health department), to be sure that it is currently functional, until city utilities are brought onto the site. If the septic tank has recently been pumped, please provide that documentation to the health department.

Thank you,

Holly Erdman  
Environmental Health Specialist II

---

**From:** Jeremiah Cromie <jeremiah.cromie@co.kittitas.wa.us>

**Sent:** Thursday, October 6, 2022 1:04 PM

**To:** Kim Dawson <kim.dawson@co.kittitas.wa.us>; George Long <long@kittcom.org>; Julie Kjorsvik <julie.kjorsvik@co.kittitas.wa.us>; Toni Berkshire <toni.berkshire@co.kittitas.wa.us>; PublicHealth Inspectors <PublicHealthInspectors@co.kittitas.wa.us>; Lisa Lawrence <lisa.lawrence@co.kittitas.wa.us>; Patti Stacey <patti.stacey@co.kittitas.wa.us>; Kelee Hodges <kelee.hodges.pw@co.kittitas.wa.us>; Codi Fortier <codi.fortier@co.kittitas.wa.us>; 'enviroreview@yakama.com' <enviroreview@yakama.com>; 'corrine\_camuso@yakama.com' <corrine\_camuso@yakama.com>; 'jessica\_lally@yakama.com' <jessica\_lally@yakama.com>; 'noah\_oliver@yakama.com' <noah\_oliver@yakama.com>; 'casey\_barney@yakama.com' <casey\_barney@yakama.com>; 'kozj@yakamafish-nsn.gov' <kozj@yakamafish-nsn.gov>; 'matj@yakamafish-nsn.gov' <matj@yakamafish-nsn.gov>; 'barh@yakamafish-nsn.gov' <barh@yakamafish-nsn.gov>; 'tebu461@ecy.wa.gov' <tebu461@ecy.wa.gov>; 'lowh461@ECY.WA.GOV' <lowh461@ECY.WA.GOV>; 'FormerOrchards@ecy.wa.gov' <FormerOrchards@ecy.wa.gov>; 'wendy.neet@ecy.wa.gov' <wendy.neet@ecy.wa.gov>; 'crosepa@ecy.wa.gov' <crosepa@ecy.wa.gov>; 'Scott.Downes@dfw.wa.gov' <Scott.Downes@dfw.wa.gov>; 'Jennifer.Nelson@dfw.wa.gov' <Jennifer.Nelson@dfw.wa.gov>; 'Elizabeth.Torrey@dfw.wa.gov' <Elizabeth.Torrey@dfw.wa.gov>; 'sepa@dahp.wa.gov' <sepa@dahp.wa.gov>; 'jorgenja@cwu.edu' <jorgenja@cwu.edu>; 'nelmsk@cwu.edu' <nelmsk@cwu.edu>; Jeremy Larson <jeremy.larson@co.kittitas.wa.us>; Steph Mifflin <stephanie.mifflin@co.kittitas.wa.us>; 'russell.mau@doh.wa.gov' <russell.mau@doh.wa.gov>; 'rivers@dnr.wa.gov' <rivers@dnr.wa.gov>; 'brenda.young@dnr.wa.gov' <brenda.young@dnr.wa.gov>; 'luke.warthen@dnr.wa.gov' <luke.warthen@dnr.wa.gov>; 'SEPACENTER@dnr.wa.gov' <SEPACENTER@dnr.wa.gov>; 'Garren.Andrews@dnr.wa.gov' <Garren.Andrews@dnr.wa.gov>; 'MARTIN.MAUNEY@dnr.wa.gov' <MARTIN.MAUNEY@dnr.wa.gov>;